

Esthetic Abutments

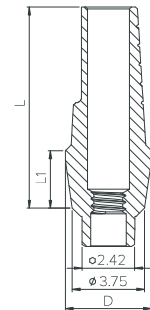
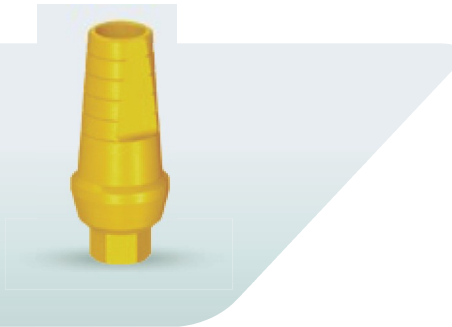

Esthetic abutments are made from titanium and built to provide an improved esthetic appearance. The esthetic abutments are available in different shapes, sizes and angulations.

Recommendation: Tighten the screw at a torque between 25 to 30 Ncm.

Material: Titanium (Ti6Al4V ELI)



Straight	Ø D (mm)	L (mm)	L1 (mm)
 NM-E4801	4.5	8.5	1
 NM-E4802	4.5	9.5	2
 NM-E4803	4.5	10.5	3
 NM-E4804	4.5	11.5	3
 NM-C1005	Available separately		

Angulated 15°	Angulated 25°	Ø D (mm)	L (mm)
 NM-E3209	 NM-E3409	4.5	9
 NM-E3211	 NM-E3411	4.5	11
 NM-S8324		Included with all abutments above & available separately	